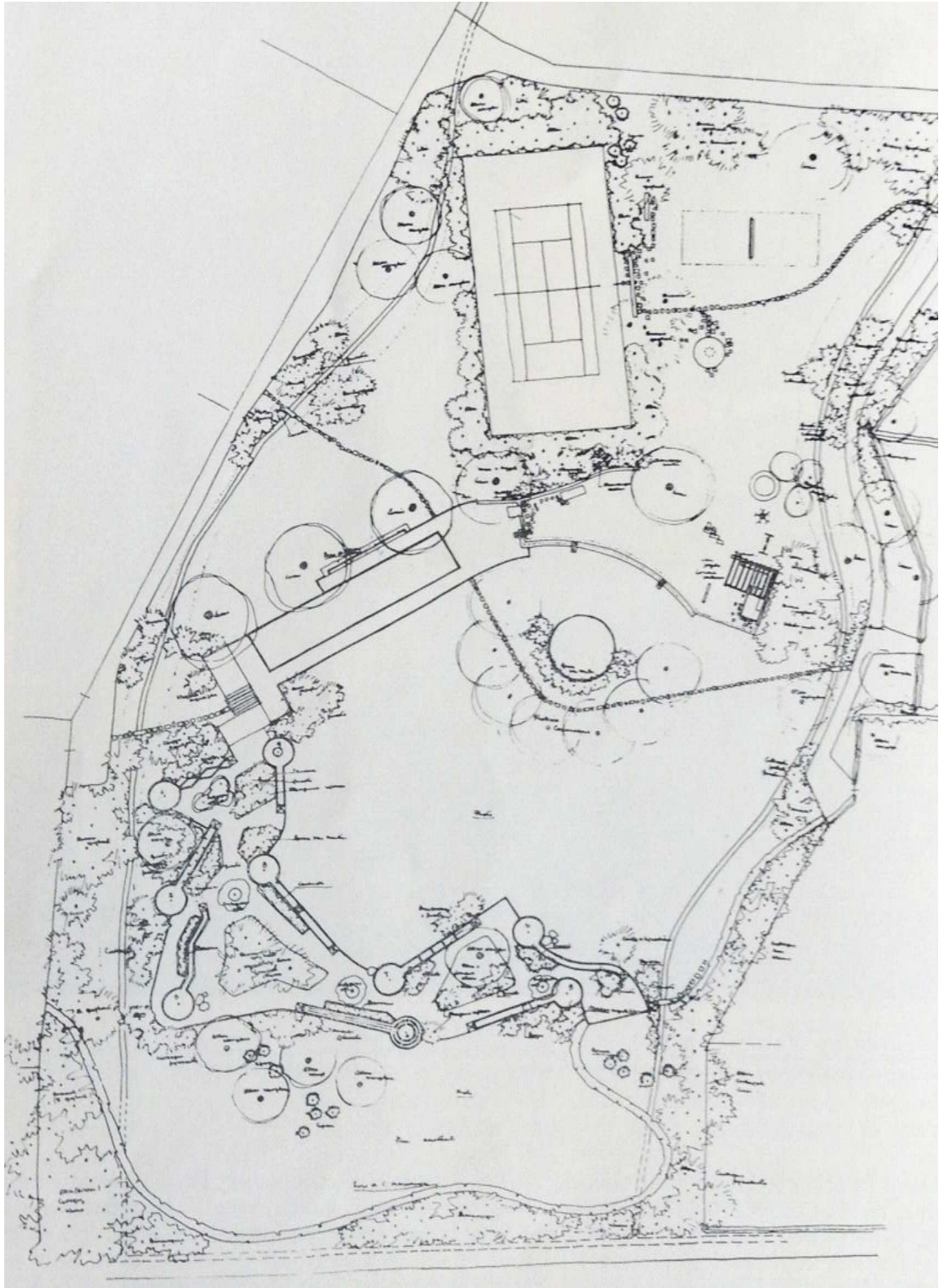



Figure_1. Maria Teresa Parpagliolo Shephard, Vigna Clara, Rome, in *Journal of Institute of Landscape Architects*, 1959-May, n. 46, page 7 (courtesy of ILA).



Figure_2. Maria Teresa Parpagliolo Shephard, Plan of Casal Palocco, Rome, in Journal of Institute of Landscape Architects, 1959-May, n. 46, page 8 (courtesy of ILA).



Figure_3. Maria Teresa Parpagliolo Shephard, View of a playground of Casal Palocco, Rome, in *Journal of Institute of Landscape Architects*, 1959-May, n. 46, page 9 (courtesy of ILA).



Figure_4. Maria Teresa Parpagliolo Shephard, View of the Hilton Hotel, Rome, in Journal of Institute of Landscape Architects, 1969-August, n. 87, page 16 (courtesy of ILA).



Figure_5. Maria Teresa Parpagliolo Shephard, View of the Hilton Hotel Park, Rome, in *Journal of Institute of Landscape Architects*, 1969-August, n. 87, page 17 (courtesy of ILA).



Figure_6. RAI Headquarter, Rome, View of the patio, 2016.



Figure_7. RAI Headquarter, Rome, View of the pool in the patio, 1966 (courtesy of RAI).

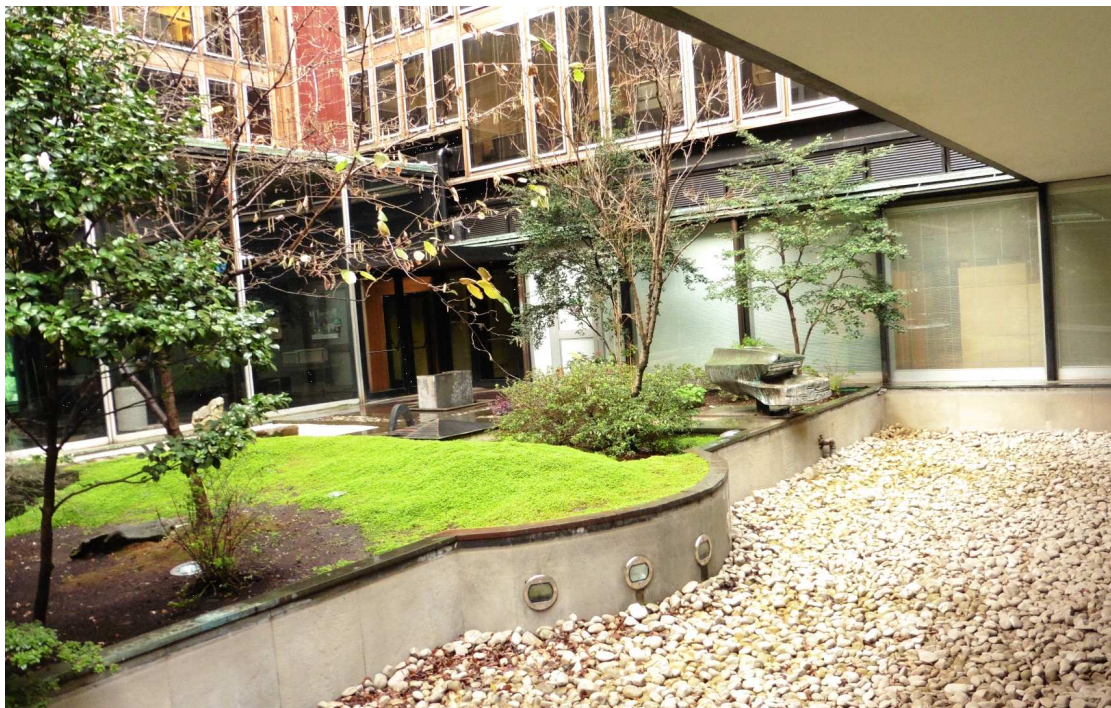

Figure_8. RAI Headquarter, Rome, View of the pool in the patio, 2016.



Figure_9. RAI Headquarter, Rome, View of the patio from the main hall, 1966 (courtesy of RAI).

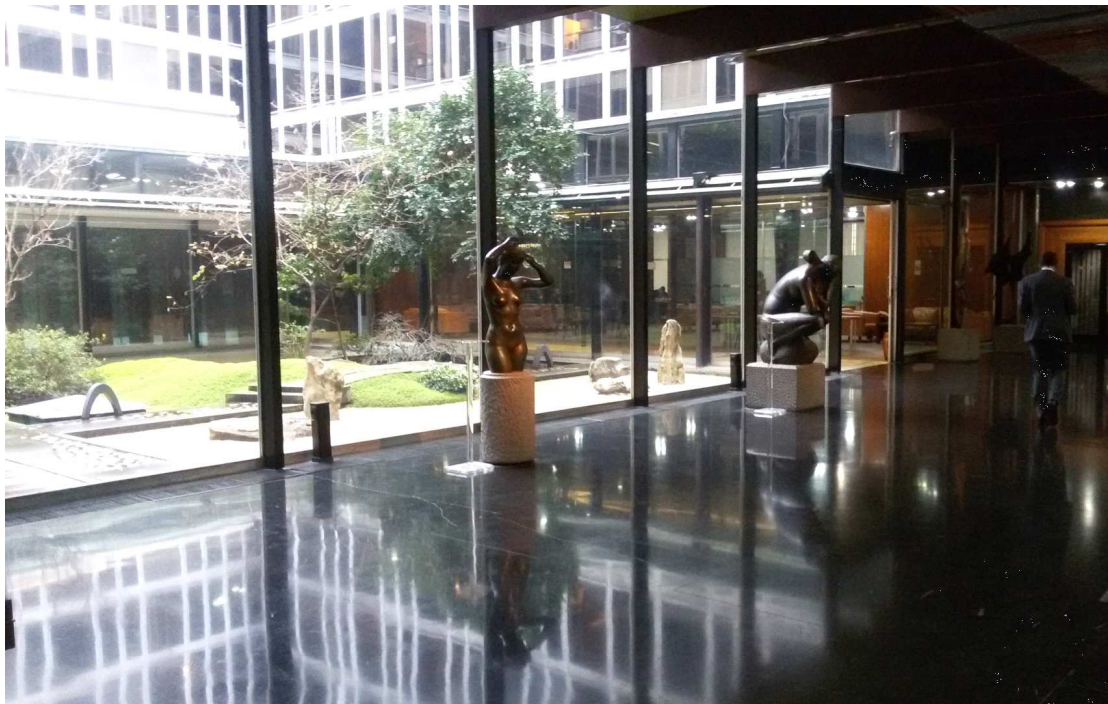

Figure_10. RAI Headquarter, Rome, View of the patio from the main hall, 2016