

EXPOSED PRÀXIS

DISPLAY

Exposed Pràxis.
The Studio and Other
Crypto-Exhibitions
of Architectural Poetics
and Intentions

EDITED BY

Fabrizia Berlingieri

WITH

Marco Addona, Serafina Amoroso, Marta Atzeni, Filippo Lorenzo Balma and Miriam Pistocchi, Alejandro Campos Uribe, José Cherem Serur, Luca Esposito, Duccio Fantoni, Luca Galofaro, Josep Maria Garcia-Fuentes, Lucia La Giusa, Jacopo Leveratto and Alessandra Bruno, Lina Malfona, Giulia Menzietti and Cino Zucchi, Isidoro Michan-Guindi, Enrico Miglietta and Jo Van Den Berghe, Vincenzo Moschetti, Gabriele Neri, Benedetta Patella, Sezin Sarıca, Giulia Setti, Annalisa Trentin

10
Exposing Pràxis. The Problem of the Studio
BY
Fabrizia Berlingieri

51 Figures/Spaces

52
Not Meant to Be Seen. The Silent Praxis of Casa Mollino
BY
Marco Addona

62
Gae Aulenti's Home-Office: a Spatial Montage
of Architecture and Theatre
BY
Serafina Amoroso

74
The Shophouse of a 21st-Century Rammendino
BY
Filippo Lorenzo Balma, Miriam Pistocchi

84
The Back Side of Piero Portaluppi's Studio
BY
Lucia La Giusa

94
Vico Magistretti Foundation. From Studio to Museum,
and Back Again
BY
Gabriele Neri

104
Gianfranco Frattini: an Atelier-Manifesto
BY
Benedetta Patella

114

Ezio Bruno De Felice. An Architectural Office on the Edge
of the Mediterranean

BY

Luca Esposito

124

Back to the Future, Fortuny's Search for Lost Time in Venice

BY

Josep Maria Garcia-Fuentes

134

Constructed Provocations

BY

José Cherem Serur

144

The Atelier as an Urban Microcosm

BY

Duccio Fantoni

154

The Museum of Innocence. Writing a Museum

BY

Luca Galofaro

162

Rooms with a View. The House-Atelier of Bijoy Jain,
Studio Mumbai

BY

Giulia Setti

172

Seamless. Peter Märkli's First Room

BY

Vincenzo Moschetti

180

Oswald Mathias Ungers. House in Belvederestraße

BY

Annalisa Trentin

192

The Archive and its Affects

BY

Alejandro Campos Uribe

202

Between a Quadreria and a Man's Cave. On Fernando Higuera's 'Rascainfiernos'

BY

Jacopo Leveratto, Alessandra Bruno

212

Bridging Cultures and Time. The Noguchi Museum in New York

BY

Marta Atzeni

222

Collecting as a Design Strategy. Philip Johnson's Glass House

BY

Lina Malfona

232

Collecting on Cloud/s. Architectural Imaginaries and the Archive of Affinities

BY

Sezin Sarica

243 Dialogues/Intentions

244

From Room to Room: Portraits of an Architect through the Thickness of Time

BY

Enrico Miglietta, Jo Van Den Berghe

262

Collecting Objects, Designing Unveilings

BY

Giulia Menziatti, Cino Zucchi

Taller Isidoro Michan-Guindi

BY

Fabrizia Berlingieri, Isidoro Michan-Guindi

292 **Bibliography**

300 **Biographies**

Taller Isidoro Michan-Guindi

BY

Fabrizia Berlingieri
Isidoro Michan-Guindi

I first met Isidoro Michan-Guindi at the Politecnico di Milano two years ago, on the occasion of his teaching seminar *Half creatures, half something else*, held within the design studio that I coordinate. The lecture addressed the start of his practice (2019) and its earliest design experiences – restless and eccentric, as the title suggested, yet simultaneously intelligent and unexpected. At the end of the speech, I asked him about the reason behind his seemingly obsessive control of the interior spaces of the house that was under construction at the time. His answer was disarmingly concise: “You must be elegant outside, and perverse inside”.

This sentence repeatedly comes to mind when observing the pictures of his studio’s interiors. Much like in the paintings of Lowell Nesbitt, the Michan-Guindi’s officina is portrayed as an accumulation of objects without an operating subject, above all through models. Discarded materials made from waste – ordinary cardboard packaging, papier-mâché glued onto metal structures, expanded polyethylene – are stacked within a grainy spatial field, punctuated by these accumulations. They appear as three-dimensional vivisections of the design process, unfolding across multiple scales and materials, offering precise and localised insights into architectural questions or constructive details.

Moreover, the projects do not present themselves as isolated, monographic entities confined to corners or worktables within the studio. Rather, they intermingle across spaces, likely mirroring analogous migrations of themes and problems that constitute an underlying thread of Isidoro’s practice. Even the project titles themselves perhaps make this clear. They do not reference typology, site, or client, as is customary, but instead articulate architectural operations: Building with a Ramp, Building with Vaults, Building with Two Columns. Or again: Suspended House, Column House, Dome House, Uncomfortable House. In this way, design operations, constructive themes, and prototypal solutions become the primary framework through which both the author and the observer gain access to the submerged realm of Michan-Guindi’s architectural intentions and poetics. Instead of engaging in a conversation, we both agreed to let the space and the objects speak.



Stool with 10 legs II (1); © Taller Isidoro Michan-Guindi.

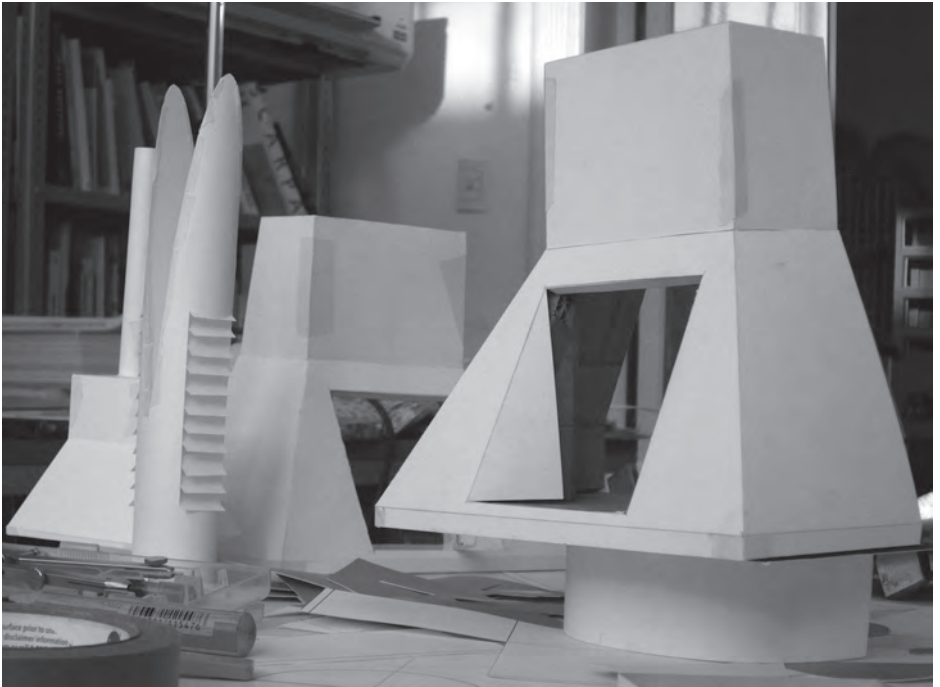

Column house (2); © Taller Isidoro Michan-Guindi.



Column house (3); © Taller Isidoro Michan-Guindi.



Suspended house w/Productora (4); © Taller Isidoro Michan-Guindi.

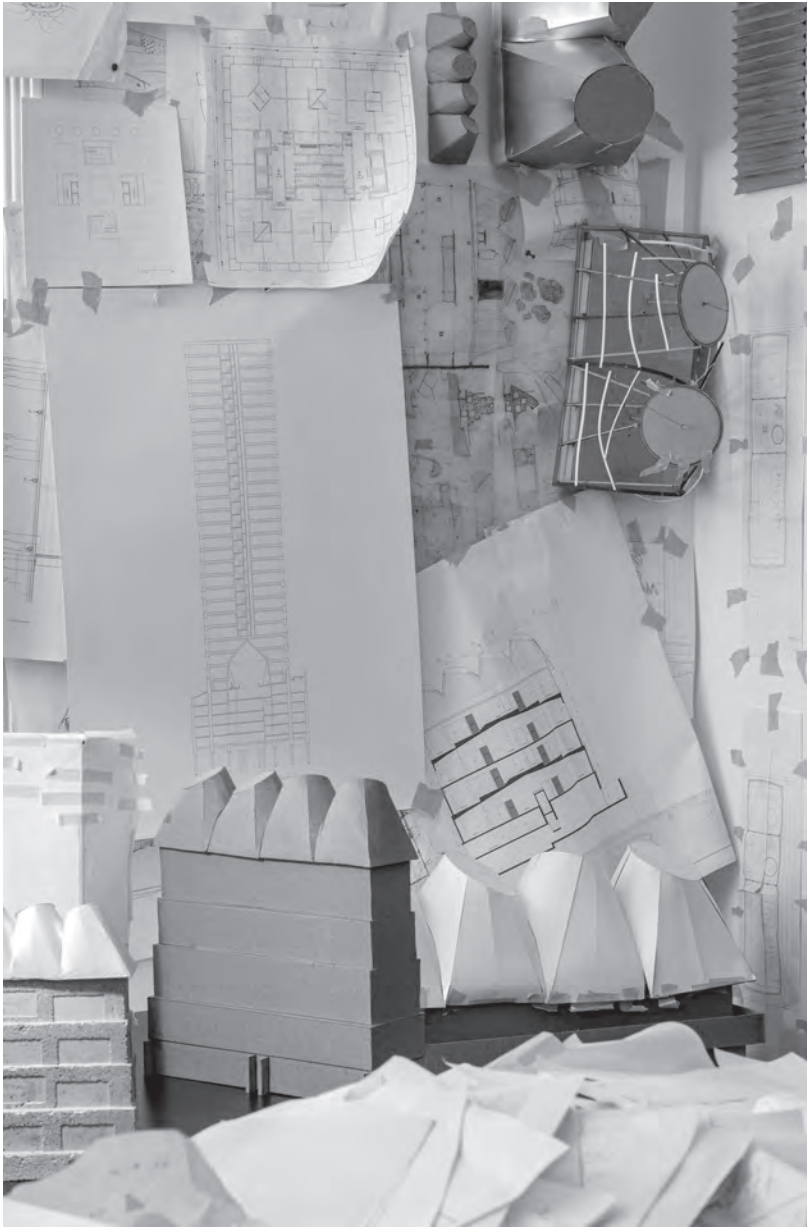

Building with a hat (5); © Taller Isidoro Michan-Guindi.

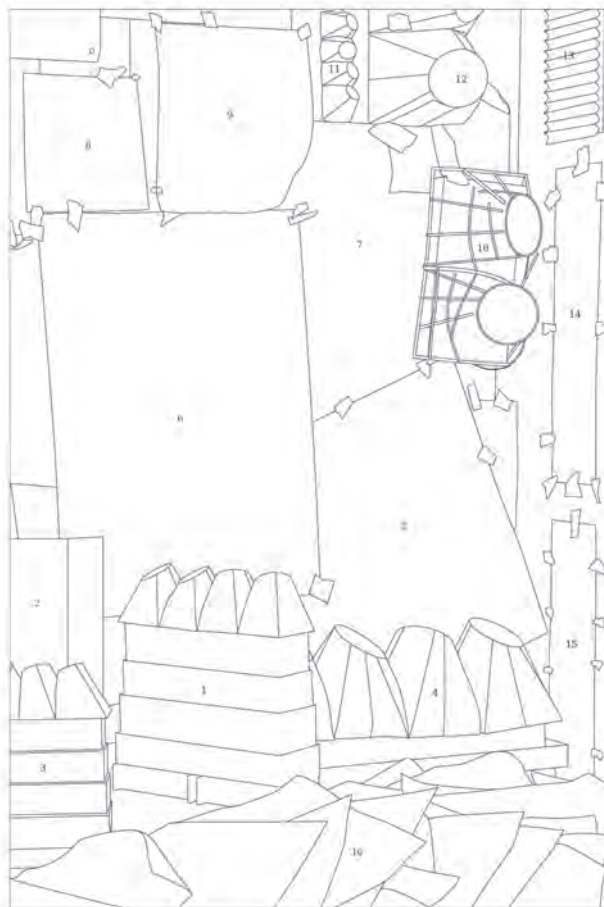

- | | |
|--|-------|
| 1. Maqueta de proporciones
carton corrugado | 1:75 |
| 2. Mod. #4
Papel bond, cinta adhesiva | 1:75 |
| 3. Estudio de materialidad
Concreto martelado, cartulina | 1:100 |
| 4. Maqueta de proporciones
Carton corrugado, cartulina,
cinta adhesiva | 1:125 |
| 5. Plano corte transversal
Papel bond | 1:50 |
| 6. Plano corte longitudinal
Papel algodon 305g | 1:125 |
| 7. Dibujo #6
Papel albaneno, marcador de color | 1:7 |
| 8. Plano PB
Papel algodon 305g | 1:200 |
| 9. Plano N3
Papel maché, cinta adhesiva, lápiz | 1:150 |
| 10. Estudio de estructura
Carton compacto, estirno | 1:25 |
| 11. Estudio de estructura
Carton corrugado | 1:100 |
| 12. Estudio de estructura
Carton corrugado, cartulina,
cinta adhesiva | 1:25 |
| 13. Maqueta de Bodega #5
Carton corrugado plata | 1:200 |
| 14. Plano N4 'A' | 1:30 |
| 15. Plano N4 'B' | 1:30 |
| 16. Montón de papeles
Bond, emaché, albaneno | 1:1 |

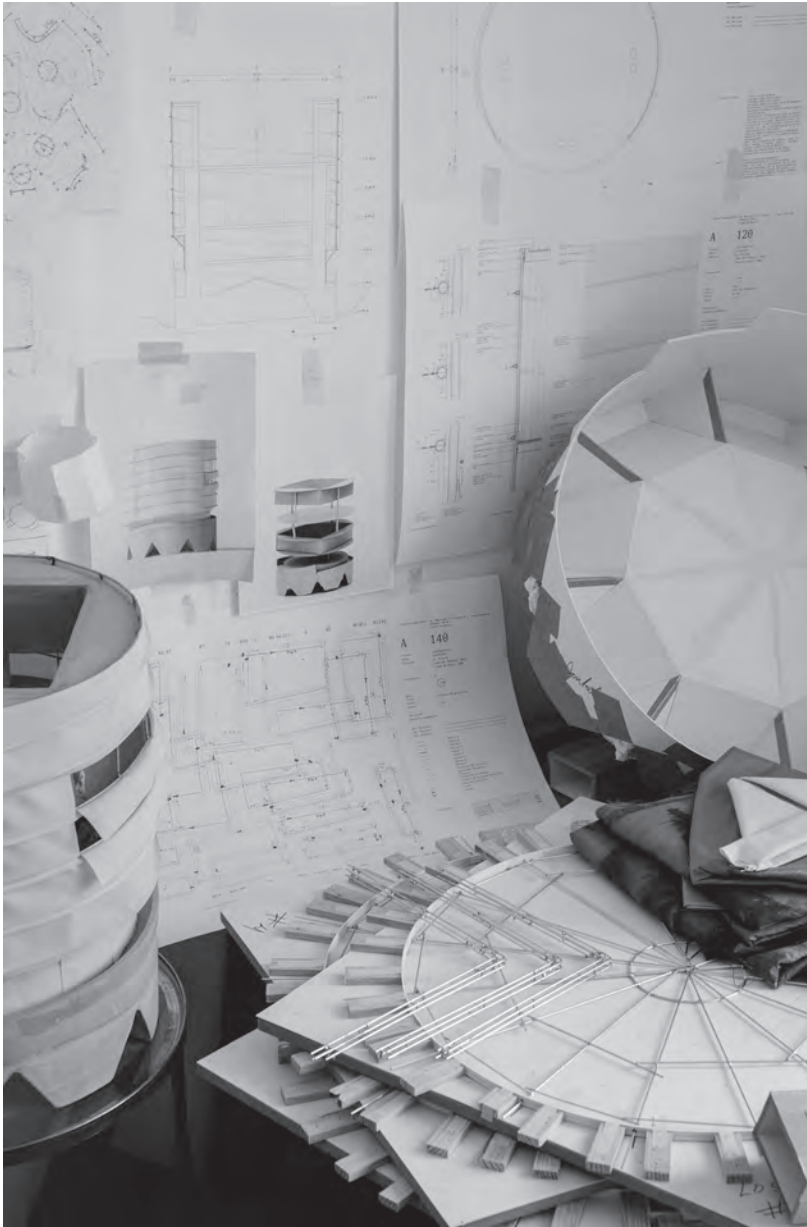

Building with a ramp (6); © Taller Isidoro Michan-Guindi.

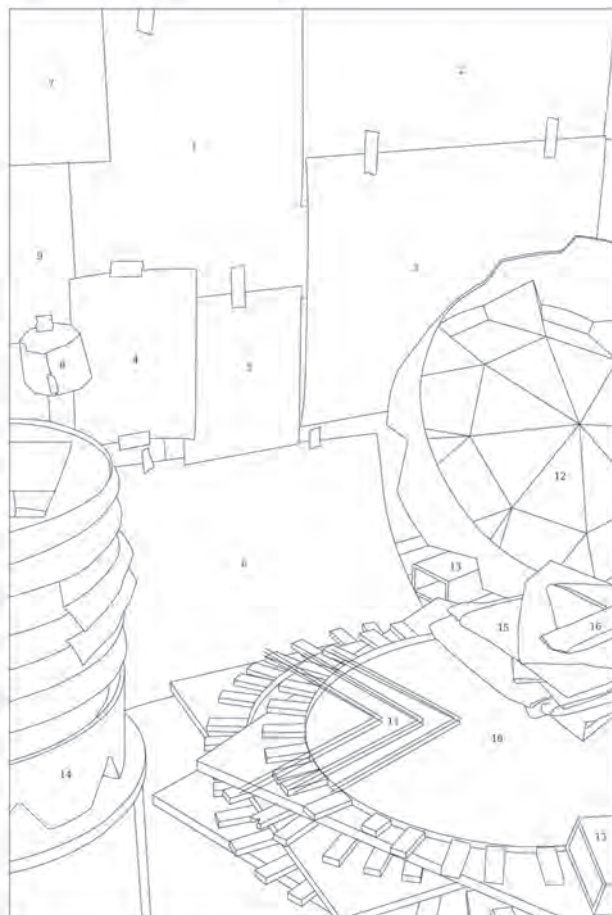

- | | | |
|-----|--|-------|
| 1. | Plano corte transversal | 1:125 |
| | Papel de algodón 385g | |
| 2. | Plano N5 | 1:100 |
| | Papel bond | |
| 3. | Corte por Fachada | 1:35 |
| | Papel bond | |
| 4. | Imej A | 1:1 |
| | Papel fotográfico brillante | |
| 5. | Estudio de Geometria | 1:250 |
| | Papel fotográfico brillante | |
| 6. | Plano de Patrones | 1:50 |
| | Papel bond | |
| 7. | Plano de envolvente | 1:200 |
| | Papel bond | |
| 8. | Mod. #12 | 1:250 |
| | Papel albaneno, cinta adhesiva | |
| 9. | Estudio de elevacion #25 | 1:200 |
| | Papel algodón 385g | |
| 10. | Armado de Acero N1 | 1:35 |
| | acero, soldadura, estireno, madera | |
| 11. | Armado Estructura en V | 1:35 |
| | Soldadura | |
| 12. | Molde para patas | 1:25 |
| | Estireno, espuma de poliuretano, cinta para ductos | |
| 13. | Molde para columnas | 1:35 |
| | Mdf 5mm, cinta para ductos | |
| 14. | Mod. #18 | 1:50 |
| | Concreto armado, tela pvc | |
| 15. | Estudio de textil | 1:1 |
| | Seda | |
| 16. | Invitacion mod. #1 | 1:1 |
| | Masta, botones | |



Suspended house w/Productora, 1:1 scale model beam connection (7);
© Taller Isidoro Michan-Guindi.



Suspended house w/Productora (7); © Taller Isidoro Michan-Guindi.



Dome house (8); © Taller Isidoro Michan-Guindi.

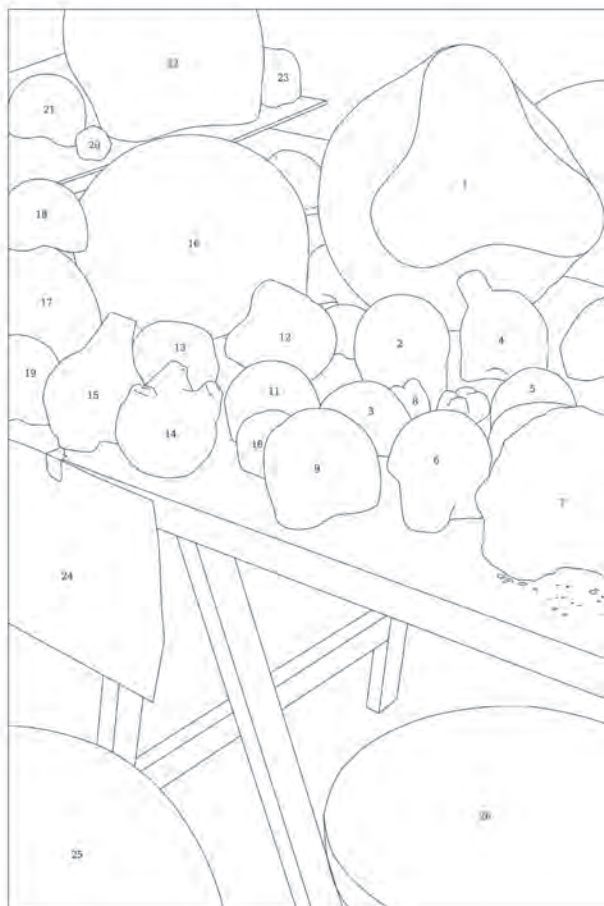

1. Armado de acero	1:50
acero, soldadura	
2. Domo dos patas	1:125
Papel maché, cinta adhesiva	
3. Estudio de aperturas	1:150
Yeso entintado	
4. Domo con cuerno	1:125
Papel maché amarillo	
5. Estudio de cimbra	1:150
Cinta de emascarar	
6. Domo con tres patas	1:200
Papel maché, cinta adhesiva	
7. Domo de pan	1:200
harina, agua, levadura	
8. Mod. #16	1:100
Cinta adhesiva	
9. Estudio de aperturas #2	1:200
Papel maché, cinta adhesiva, lapja	
10. Mod. #14	1:100
Cinta adhesiva	
11. Estudio de aperturas #3	1:100
Yeso, lápiz	
12. Mod. #06	1:150
Papel maché, cinta adhesiva	
13. Mod. #13	1:200
Cinta adhesiva	
14. Domo tres cuernos	1:75
Papel maché	
15. Domo cuerno y patas	1:50
Papel maché, cinta adhesiva	
16. Maqueta de proporciones #1	1:50
Unicel, pegamento	
17. Mod. #26	1:75
Pasta de modelar	
18. Estudio material	1:100
Yeso martelinado	
19. Domo tres patas	1:50
Papel maché	
20. Mod. #25	1:75
Papel aluminio	
21. Estudio material	1:100
Yeso martelinado	
22. Maqueta de proporciones #2	1:75
Unicel, pegamento	
23. Mod. #15	1:200
Cinta adhesiva	
24. Plano N0	1:150
Papel bond	
25. Armado de acero #2	1:25
Unicel, alambre de acero	
26. Prototipo B 'Banco robot'	1:1
Madera primavera, cables electricos, arduino, sensores, motores, switches	



Column house (9); © Taller Isidoro Michan-Guindi.

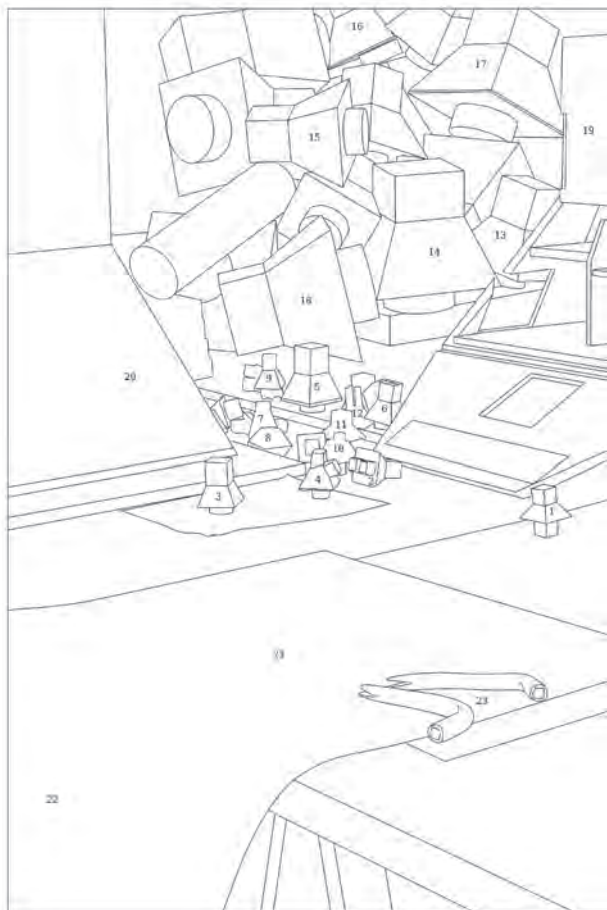

- | | | |
|---------------------------------|------------------------------------|-------|
| 1. Mod. #13 | cinta adhesiva | 1:200 |
| 2. Casa dos patas | concreto | 1:200 |
| 3. Mod. #32 | aluminio fundido | 1:200 |
| 4. Casa con brazo | papel, cera | 1:200 |
| 5. Maqueta de proporciones | carton corrugado | 1:150 |
| 6. Mod. #31 | cartulina metalizada | 1:200 |
| 7. Mod. #26 | yeso | 1:200 |
| 8. Casa sin cabeza | papel, cinta adhesiva | 1:200 |
| 9. Mod. #15 | papel, cinta adhesiva | 1:200 |
| 10. Mod. #13 | papel, cinta adhesiva | 1:100 |
| 11. Casa con falda | papel, cinta adhesiva | 1:100 |
| 12. Casa tres patas | papel, cinta adhesiva | 1:200 |
| 13. Maqueta de aperturas #3 | carton corrugado, lapiz | 1:100 |
| 14. Maqueta de aperturas #2 | carton corrugado, lapiz | 1:75 |
| 15. Maqueta de proporciones #4 | carton corrugado | 1:50 |
| 16. Maqueta de aperturas #4 | carton corrugado | 1:50 |
| 17. Mod. #42 | carton corrugado | 1:75 |
| 18. Maqueta aperturas | carton corrugado, cera, lapiz | 1:75 |
| 19. Maqueta de interior #1 | carton corrugado, cinta adhesiva | 1:25 |
| 20. Armado de acero | Metal, sulf, triplay | 1:25 |
| 21. Plano N1 | Papel de algodón liso | 1:50 |
| 22. Plano N0 | Papel de algodón liso | 1:50 |
| 23. Manijas o pistolas de rayos | Aluminio fundido, soldado en arena | 1:1 |

Credits

Collaborators:

Mads Bjørn Christiansen

Column house
Suspended house
Dome house
Building with hat

Sina Ozbudun

Building with a ramp

Office team:

Luis Iván Méndez González
Mariel Avilés Mariscal
Salvador Gómez Correa
Lou Simonett

* Drawings corresponding to photographs developed for the exhibition:

LIGA 36 "Hybrid Creatures"

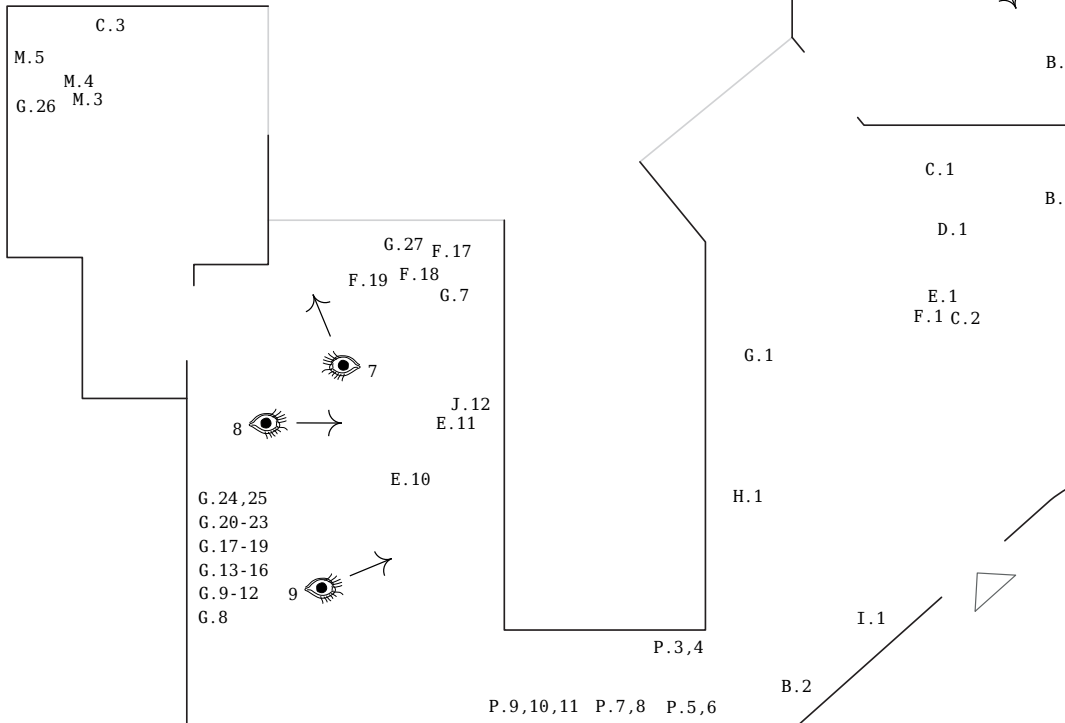

Officina studio floor plan; © Taller Isidoro Michan-Guindi.

OF 01

Proyecto Oficina
 Fecha 24/11/2025
 Ubicación Av. Mazatlán 5-6, acceso N
 Condesa, 06140
 Ciudad de México

Plano Levantamiento
 Clave OF-01
 Escala 1:50

Revisiones
 Proyecto esquemático

1ra. Revisión _____
 2da. Revisión _____
 3ra. Revisión _____

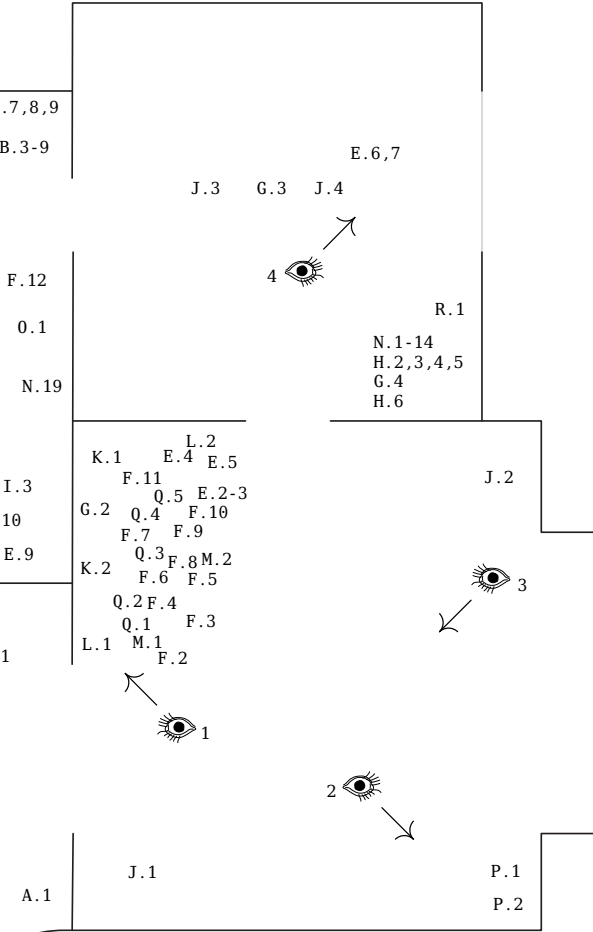

- A. Uncomfortable house
- B. Building with a hat
- C. Building with 2 columns
- D. Building with vaults
- E. Suspended house
- F. Stool with 10 legs
- G. Column house
- H. Tower with 4 legs
- I. Building with 4 legs
- J. Chair for one person and a half
- K. Building with a ramp
- L. Stool with 10 legs II
- M. One plate for two
- N. Dome house
- O. Building with 3 legs
- P. Varieties of Disturbance
- Q. Toy
- R. Trajinera

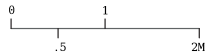

BIOGRAPHIES

MARCO ADDONA graduated in Architecture in 2016 and earned his PhD in Architecture at Sapienza University of Rome in 2025. His doctoral research focuses on the work of Carlo Mollino, with particular attention to his interior designs and their theoretical implications. Since 2014, he has been teaching as a tutor in architectural design and theory courses at university level. His research interests include domestic, residential, and social space, explored as environments deeply intertwined with the lives of their inhabitants, and considered through philosophical and psychological lenses.

SERAFINA AMOROSO architect (Università degli Studi di Firenze, 2001), PhD in Architectural and Urban Design (Università Mediterranea di Reggio Calabria, 2006), MA in Advanced Architectural Design (ETSAM, Madrid, 2012), MA in Applied Research in Feminist, Gender and Citizenship Studies (Jaume I University, Castellón de la Plana, 2016). She has been working as an adjunct professor at the School of Architecture of Florence since 2007 for almost 12 years. She is currently working as Lecturer in Architectural Design Areas at the Universidad Rey Juan Carlos (Madrid). One of her main fields of research is focused on gender perspectives, feminism, care and their relationships with space and education, as reflected in the production of essays and articles published in such journals as “Bracket”, “CLOG”, “VAD”, “ÁBACO”, “Asparkía”, “ARQ”, “Interiority”.

MARTA ATZENI received her Master's degree in Architectural Design from Università degli Studi Roma Tre. She is currently a PhD candidate in Architecture, Theories and Design at University of Camerino (UNICAM) researching the contemporary evolution of the relationship between architecture and art within the framework of exhibitions. She is a member of the UNICAM research unit in the PRIN 2022 project 'Display: the presence of future. An archive/laboratory of the immaterial heritage of architectural exhibitions'. Since 2013 she has been a regular contributor to design and cultural magazines, and has collaborated with cultural institutions such as MAXXI and the Lithuanian Council of Culture on exhibition and editorial projects. She lives in London.

FILIPPO LORENZO BALMA is a researcher in Architecture with a keen interest in the intersections between architecture, media, and politics. His work primarily explores themes of intimacy, privacy, and surveillance within the context of design culture. After gaining international experience at EPFL in Lausanne and UPC in Barcelona, he graduated from the Politecnico di Torino with a thesis offering a critical reflection on domestic space, later published in the volume *Domestico e Anti-domestico. Il progetto dell'intimità radicale* (LetteraVentidue, 2023). He is currently engaged in research and teaching at the Politecnico di Torino and Milano and is a PhD candidate at the Department of Architecture and Urban Studies, Politecnico

di Milano. His doctoral research, conducted in collaboration with Triennale Milano, investigates the spatial dimension of archival landscapes and data architectures.

FABRIZIA BERLINGIERI PhD architect, is associate professor of Architectural and Urban Design and a faculty member of the PhD program in Architectural, Urban and Interior Design (AUID) at the Department of Architecture and Urban Studies (DASU), Politecnico di Milano. From 2009 to 2019, she was founder and principal of BAS_Berlingieri Architetti Studio, operating across both national and international contexts and earning several competition awards. From 2011 to 2013, she was a Postdoctoral Fellow within the program 'Excellence Pathways in Research', conducting research at both the Department of Architecture and Territory (DARte) in Reggio Calabria with Laura Thermes and the Department of Architecture at TU Delft with Tom Avermaete and Roberto Cavallo, where she held the position of guest researcher from 2012 to 2013 and from 2015 to 2017. From 2014 to 2016, she was member of the Expert Team for the Internationale Bauausstellung (IBA) Parkstad, collaborating with the curator Jo Coenen on the territorial research project *Mutations*, and co-editor of the *IBA Manual, Summer 2015*. She currently serves as scientific board member for the 'Craft-Competence Center for Anti-Fragile Territories' at DASU.

ALESSANDRA BRUNO architect and PhD candidate in Architectural, Urban and Interior Design at Politecnico di Milano. Her research looks into the atmospheric dimension of architecture, exploring its complexity as a constructed phenomenon. With a background in architecture, interior design, and urban domestic spaces, her work deepens the awareness of how design shapes lived experiences, and how spatial atmospheres can be intentionally crafted and critically examined to question and enhance contemporary architectural practice.

ALEJANDRO CAMPOS URIBE is an assistant professor at the Department of Architecture, Universitat Politècnica de València, specialising in Modern Architecture and the colonial dynamics behind its universalising claims. Between 2021-2024, he worked as a Marie Skłodowska-Curie Individual Fellow at TU Delft, and Research Associate at the Research Center for Material Culture, where he developed the research project 'Multiculturalism in the work of Aldo and Hannie van Eyck'. He is also a research affiliate at the Jaap Bakema Study Centre within Nieuwe Instituut, Rotterdam. His latest outcome is the exhibition *Built Homecoming: The house of Aldo and Hannie van Eyck* with Dirk van den Heuvel, shown at the Nieuwe Instituut between September 2024 and March 2025.

JOSÉ CHEREM SERUR, is an architect, holds a Master of Sciences from Politecnico di Milano, following previous education at Universidad Iberoamericana in Mexico City. Since 2024, he has been part of the AUID PhD program, where he is involved in teaching and research on the topics of adaptability and flexibility as a compositional strategy and theoretical category. Over the years, he has worked in Mexico, Argentina and Italy and collaborated with various architecture practices on a variety of projects and scales of private and public buildings. Most recently he works as an independent architect.

LUCA ESPOSITO is a PhD architect in Philosophy of Interior Architecture at the Department of Humanities, University of Naples Federico II. Mainly engaged in the study of Exhibit Design and Interior Architecture and the phenomenology of living, in the relationship between reuse of existing architectural heritage, furniture and multisensory perception. In the same university, at the Department of Architecture, he is tutor of the Interior Architecture courses, performing teaching support activities. He is a guest research fellow at the University of Hasselt in Belgium.

DUCCIO FANTONI is an architect and PhD candidate at the Politecnico di Milano, Department of Architecture and Urban Studies (DASTu) with a research titled *Unscripted Architecture: The Yards of Tbilisi*. In 2024, he was awarded a research fellowship by Fondazione Fratelli Confalonieri. He studied architecture at the University of Ferrara and Waseda University in Tokyo, graduating cum laude in 2018 with a thesis on Ostia Antica Archaeological Park. In 2020, he co-founded NOIA practice, an architecture and landscape studio based in Prato and Tbilisi, dedicated to adaptive reuse and transitional landscapes. He has been a teaching assistant at the Politecnico di Milano, a visiting lecturer at Visual Arts, Architecture & Design School of the Free University of Tbilisi, and a jury member of Tbilisi Architecture Biennial 2024.

JOSEP MARIA GARCIA-FUENTES is an associate professor in the Department of Architecture and Urban Studies at the Politecnico di Milano. His research explores the intersections between architecture, nature, ecology, the environment, and experimental preservation. He has previously held positions at the School of Architecture, Planning, and Landscape at Newcastle University and the School of Architecture of Barcelona (UPC-BarcelonaTECH). Fellow at the London School of Economics (UK) and Visiting Professor at Tongji University and the Universidad de Concepción. In practice, he has collaborated with Juan Navarro Baldeweg and is the co-founder of the Milan-based studio BMBR, alongside Marco Chiodi.

LUCA GALOFARO is an architect and associate professor at the University of Camerino, School of Architecture and Design. He is one of the founders of the architecture firm IaN+, with which he has participated in major international exhibitions, including several editions of the Venice Biennale. In 2006, he was awarded the Gold Medal for Best First Work by the Milan Triennale, and in 2013 he was a finalist for the Aga Khan Award. He

has taught Urban Design at UCL-The Bartlett School of Architecture in London and has been a Visiting Professor at the École Spéciale d'Architecture in Paris and Cornell University. He is the author of the blogs "The Booklist" and "The Imagelist".

LUCIA LA GIUSA is an architect and PhD in architectural and urban design. Until 2019, she was part of the research group Landscape_in Progress (Università degli Studi Mediterranea di Reggio Calabria), working on *Paesaggi in Divenire*. In 2018 and 2025, she participated at the Venice Biennale, exhibiting for the Former Yugoslav Republic of Macedonia Pavilion. She has won numerous architecture competitions. She participates and tutors in national and international workshops and seminars. Currently she is a research fellow at the Politecnico di Milano.

JACOPO LEVERATTO, PhD architect, is an associate professor in Interior Architecture and Exhibit Design at the Department of Architecture and Urban Studies of Politecnico di Milano. Focusing his research on critical spatial practices, he has authored numerous publications in peer-reviewed international journals and edited volumes. Besides having published different monographs, he is an associate editor of the peer-reviewed journals "Stoa", "ARK" and "iijournal", and he has written on "Architectural Design", "Area", "Interni" and "Vesper".

LINA MALFONA is an associate professor in Architecture, and founder of the research lab Polit(t)ico. She studied in Rome under Franco Purini, and she earned a PhD in Architectural and Urban Design. She has received various fellowships, including one from the Fulbright Foundation to pursue research at the Institute of Fine Arts at NYU, and has been a Visiting Scholar at the Canadian Centre for Architecture (CCA). She has taught at multiple Schools of Architecture, including Cornell University (Ithaca, NY). Her publications include essays on the history, theory

and criticism of architecture. Among her most recent books are *The Mannerist Phase in Architecture. On Early Style* (Routledge 2025), and *Residentialism. A Suburban Archipelago* (ACTAR 2021). Her essays have appeared in many architectural journals, including “Domus”, “Log”, and “The Journal of Architecture”. The architectural firm *Malфона Petrini Architettura*, of which she was the founder, has received recognition and acclaim.

GIULIA MENZIETTI is an architect and assistant professor at the Eduardo Vittoria School of Architecture and Design in Ascoli Piceno, University of Camerino. She holds a PhD from the International Villard d'Honnecourt Program at IUAV University of Venice and she has participated in several national and international research projects, as well as in numerous conferences with peer-reviewed contributions. She is the author of *La cartiera Mondadori di Ascoli Piceno* (Libria, 2024) and *Amabili resti. Frammenti e rovine della tarda modernità italiana* (Quodlibet, 2017). Her work has appeared in various architecture publications.

ISIDORO MICHAN-GUINDI earned his Master's Degree in Architecture from Princeton University in 2018. He received his Bachelor's Degree in Architecture from Cornell University in 2015. He lives and works in Mexico City where he has had his studio Taller Isidoro Michan-Guindi since 2019.

ENRICO MIGLIETTA is an architect and PhD in Architectural, Urban and Interior Design (Politecnico di Milano and KU Leuven). He is research associate at KU Leuven, Department of Architecture. His research explores architectural detailing as a site of embodied knowledge, cultural continuity, and material expression. In 2024 he co-founded Atelier Vetia with Briselda Calliku, a critical reflective practice bridging professional, academic, and research experiences. Their work focuses on dwelling, exhibition design, and architectural restoration, with particular

attention to reuse and heritage enhancement. Since 2016, he has taught in design studios and international workshops at Politecnico di Milano, KU Leuven, and Università Iuav di Venezia, focusing on preservation and regeneration of the European city's cultural heritage.

VINCENZO MOSCHETTI is a PhD architect and researcher in Architectural and Urban Design at the Department of Architecture and Design - Sapienza University of Rome. He was a research fellow (2020-2023) at the Department of Architecture and Arts, Iuav University of Venice and a lecturer (2022-2023) in Interior Architecture and Architectural Design at the University of Ferrara. His scientific and teaching activity is dedicated to the theoretical aspects of architectural design, and in particular to the relationships between design and authorship, and between architecture, geography and nature.

GABRIELE NERI is an architectural and design historian, curator, and PhD architect. He is associate professor of Architectural History at the Politecnico di Torino (Department of Architecture and Design - DAD). He was the Weinberg Fellow in Architectural History and Preservation at the Italian Academy for Advanced Studies in America, Columbia University, New York (Spring 2022), Maître d'enseignement et de recherche at the Accademia di architettura in Mendrisio (2019-2022), and adjunct professor at the Politecnico di Milano (2011-2022). Since 2024, he has been a member of the Scientific Committee of the MAXXI Foundation in Rome; he previously served on the Board of Directors of the Triennale Milano Design Museum Foundation (2018-2021). He is also a member of the Scientific Committee of the Vico Magistretti Foundation in Milan.

BENEDETTA PATELLA is an architect and PhD candidate in Architectural Urban and Interior Design at the Politecnico di Milano, her research focuses on domestic interiors, with a particular emphasis on the work of Gianfranco Frattini. She contributed to the

exhibition dedicated to the architect (April 2023), curating the academic section and collaborating on the catalogue *Gianfranco Frattini. Design 1955/2003*, Silvana Editoriale. Her work has been published in “ARK”, “Op. Cit”, and featured at international conferences.

MIRIAM PISTOCCHI is an architect and PhD candidate in Architecture, Urban and Interior Design at Politecnico di Milano. Her research interests stem from the domestic space, exploring the relationship between space and modes of dwelling. Her doctoral research focuses on the representation of domestic space in architecture exhibitions. She has collaborated with various architecture studios in the fields of exhibition and interior design. She writes about architectural projects and books, contributing to “Abitare” magazine and previously to “Artribune” and “IIC”. In 2020, she presented the video *Rituali domestici* as part of the exhibition *La casa non domestica*, curated by Gabriele Mastrigli at Galleria Contemporary Cluster in Rome. She is a member of the research group for the PRIN project ‘Display: The Presence of the Future. An Archive/Laboratory of the Immaterial Heritage of Architectural Exhibitions’.

GIULIA SETTI is a PhD architect and assistant professor of Architectural and Urban Design at Politecnico di Milano, Department of Architecture and Urban Studies. Her research focuses on the reuse of industrial architecture and on new typologies of contemporary public spaces. She participates in the board of ‘CRAFT-Competence Center Anti-Fragile Territories’ coordinated by DASTU as Department of Excellence 2023-2027. In 2014-2015, she conducted research and teaching activities at CEPT University, Ahmedabad, India; in 2022, she published the volume *Stepwell. Architetture per l’acqua nel Gujarat. Tra valorizzazione, progetto e recupero* a typological study of ancient wells in India.

SEZIN SARICA is a PhD architect graduated from the METU Faculty of Architecture,

where she is currently a research assistant. Her research focuses on the interaction of art and architecture, 19th-century German architectural theory, especially the concept of *Bildung*, and methodologies of making and collecting. She is a member of the EAHN research group ‘Building Word Image’. She has been a short-term visiting researcher at the KIT Program in Architectural Theory and the TU Munich Architekturmuseum. She has contributed to various academic platforms and journals, including “JoLa”, and has presented her research at international conferences such as EAHN, AHRA, and DocTalks. She was part of the curatorial team for the Archive Exhibitions (Getty Foundation - ‘Keeping It Modern’) at METU and TU Delft.

ANNALISA TRENTIN is professor in Architectural and Urban Design at the Department of Architecture, Alma Mater Studiorum University of Bologna, former Coordinator of the PhD program in Architecture and Design Cultures of the University of Bologna. She carries out research and teaching activities, mainly dealing with the relationship between architecture, theory, and practice. Within this line of research, she has organised several exhibitions and seminars, among others, on the work of Pier Luigi Nervi, Aldo Rossi, and Oswald Mathias Ungers in collaboration with CSAC, MAXXI - Rome, Princeton University, UAA - Ungers Archiv. She is author of essays on architecture criticism and theory, has organised and has participated to several conferences, international workshops, Summer Schools, design competitions and EU funded projects, always looking at an innovative and interdisciplinary way of thinking pedagogy and university teaching.

JO VAN DEN BERGHE is professor of Architecture at KU Leuven, Department/Faculty of Architecture. He graduated from the Sint-Lucas School of Architecture in 1984 and has maintained a critical reflective practice since 1986. From 1984 to 2019, he was

intern and collaborator of Juliaan Lampens. In 2012, he obtained a practice-based PhD from RMIT University Melbourne. He is co-founder, with Thierry Lagrange, of the Research Group 'The Drawing and the Space'. At KU Leuven, he teaches experimental architectural design within the ADO Studio Anatomy, where he investigates the tension field between Techné and Poiesis in making architecture – the poetics of making – through innovative drawing formats, with the drawing as the indispensable locus of investigation. He served as Program Director of the Faculty of Architecture at KU Leuven from 2017 to 2022. He has been visiting professor at Politecnico di Milano, EPFL Lausanne, Queen's University Belfast, and RMIT University Barcelona.

CINO ZUCCHI earned a Bachelor of Science in Architecture and Design (B.S.A.D.) at the Massachusetts Institute of Technology and a master's degree in Architecture from Politecnico di Milano, where he is currently professor of Architectural and Urban Design. He has taught in numerous international design workshops and has served as 'John T. Dunlop Visiting Professor in Housing and Urbanization' at the Harvard University Graduate School of Design. He is author of several articles and books on architectural history and theory and participated in various editions of the Triennale di Milano and the Venice Architecture Biennale. His installation *Copycat* received an honorary mention at the 2012 edition, and he was curator of the Italian Pavilion for the 2014 edition. He served as president of the Jury of the Mies van der Rohe Award 2015 and is a member of the international research team ARE_Living, focusing on housing innovation.

I would like to express my gratitude to Alessandro Rocca, the Polimi Research Unit for their support throughout the preparation of this book. Duccio Fantoni, Lucia La Giusa, Filippo Lorenzo Balma, Levan Eloshvili for the contribution to the drawings. Serafina Amoroso, Vanessa Marcella, Ettore Rocca, and Manuela Triggianese for their suggestions.

Mimesis Edizioni
piazza Don Enrico Mapelli, 75
20099 Sesto San Giovanni (MI)
www.mimesisedizioni.it

First Edition
March 2026

ISBN
(Print) 9791222330877
(Online) 9791222330884

DOI
10.7413/1234-1234107

Printed in March 2026

Fonts
Suisse Works, Swiss Typefaces

2026 Mimesis Edizioni
Images and texts
© The Authors
Graphics - Drawings
© Fabrizia Berlingieri, Levan Eloshvili

Funded by the EU - Next Generation EU -
PRIN 2022 call - D.D. n. 104 of 2 February
2022 - M4 C2 Inv. 1.1 Prot. No. 2022XJ8CXS
- Project title: "Display: the presence of future.
An archive/laboratory of the immaterial
heritage of architectural exhibitions" - CUP:
D53D23015660006.

The book is available in open access with Creative
Common Attribution-Non Commercial-No
Derivative 4.0 International License (CC BY-NC-
ND 4.0). Each volume in the Display series is
reviewed by referees chosen from members of the
Scientific Committee. For the images contained
in this volume the authors remain at the disposal
of any rights holders that could not be traced.
The rights of translation, electronic storage,
reproduction and adaptation, even partial, by any
means, are reserved for all countries.

Display Books

The series Display Books is a project of the
Research Unit of Politecnico di Milano within
the PRIN 2022 "Display: the presence of future.
An archive/laboratory of the immaterial heritage
of architectural exhibitions" composed by
the Research Units of Politecnico di Milano,
Università degli Studi di Camerino, Università
degli Studi di Napoli Federico II.

Directed by
Alessandro Rocca
Politecnico di Milano

Graphic Layout
Studio Pupilla, Milano

Scientific Committee
Fabrizia Berlingieri
Politecnico di Milano
Pippo Ciorra
Università degli Studi di Camerino
Stamatina Kousidi
Politecnico di Milano
Pasquale Miano
Università degli Studi di Napoli Federico II
Carles Muro
Politecnico di Milano
Giulia Setti
Politecnico di Milano



DIPARTIMENTO
DI ARCHITETTURA
E STUDI URBANI

